

Termination Instructions

100-181 Excel Cat6A Screened Toolless Keystone Jack

Tools Required:

- Peg-Style Cable Stripper
- Multi-Purpose Side Cutter



Termination Video:

Scan this QR code to watch the Excel "How To Video" of this termination.



PREPARE THE CABLE

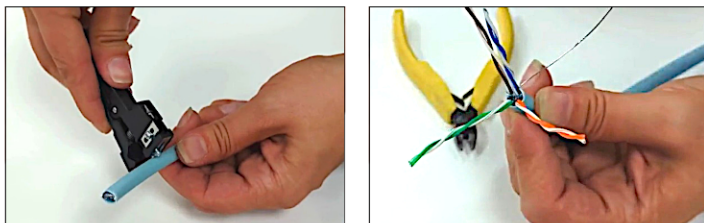

- Strip approximately 40mm of the outer sheath using a cable stripper (for double-sheathed cables, strip 80mm of the first sheath, then 40mm of the inner sheath).
- For cables with foil around the pairs, snip and remove the foil, avoiding the drain wire. For cables with braid, twist it to form a drain wire. Trim any excess rip cord.

POSITION THE CABLE

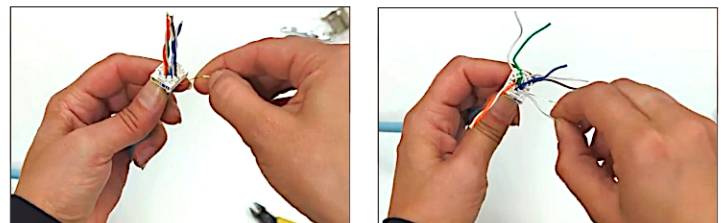

- Insert the cable through the termination cap, ensuring the pairs are fanned out and ready for positioning.

PREPARE THE WIRES

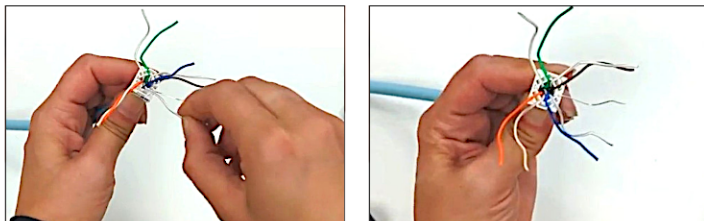

- Untwist the pairs and arrange them according to the colour code on the termination cap.
- Double-check that each wire is seated in its correct position.

TRIM THE EXCESS WIRE

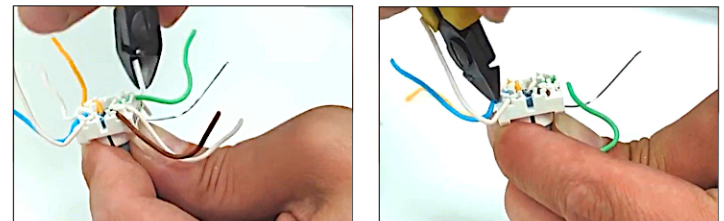

- Use flush cutters to trim the wires as close to the edge of the wire manager as possible. The tips of the wires should not protrude more than 0.5mm.

WRAP THE DRAIN WIRE

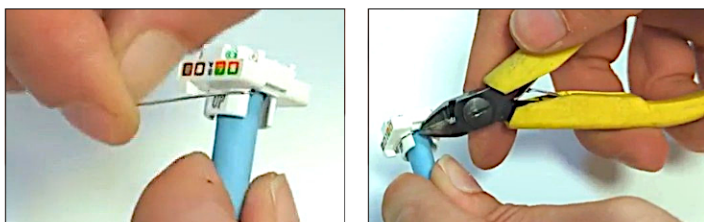

- For cables with a drain wire or twisted braid, wrap it 360° around the base of the cap, then trim any excess.

POSITION AND CLOSE THE CAP

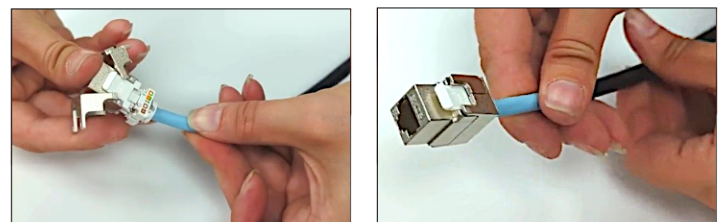

- Align the termination cap with the IDC towers, ensuring correct orientation using the "UP" marker. Push down firmly to secure.
- Rotate the wings towards each other and snap them closed, using pliers if needed.