

Audio Extension for MOBOTIX S15M/S14M



- Easy installation using adhesive film
- Integrated speaker and microphone
- Suitable for all FlexMount mono cameras
- Double-sided adhesive tape for mounting Interface Box (e.g., MX-232-IO-Box) included

Example: metall sheet not included in delivered parts

31.812-002_EN_08/2015

The AudioMount is a mounting adapter for the **S14M** and **S15M** cameras allowing attachment to thin and smooth surfaces (e.g., stainless steel plate, mailbox, etc.) using an adhesive film on the backside of the AudioMount. Speaker and microphone are included so that the AudioMount can provide full intercom functionality. Using the appropriate MOBOTIX accessories, you can also use the FlexMount camera in conjunction with the AudioMount as a hemispheric door station (door station function with firmware 4.1.9 and higher).

Delivered Parts

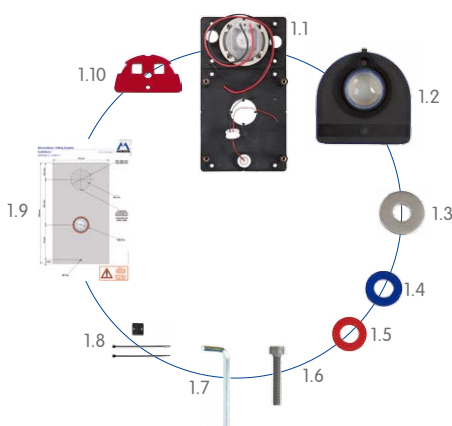

Item	Number	Part Name
1.1	1	AudioMount
1.2	1	Black front cover with dome
1.3	4	Metal washer
1.4	5	Blue washer
1.5	5	Red washer
1.6	4	Allen screw M5x20
1.7	1	Allen wrench
1.8	1	Cable tie
1.9	1	Drilling template
1.10	1	Double-sided adhesive tape for mounting Interface Box (not included)

Installation of the AudioMount

1. Choose installation site

The AudioMount can be mounted horizontally or vertically (to stainless) steel sheets 1.2 mm to 3.0 mm thick.

2. Prepare mount surface

Drill holes for the lens, the microphone and the speaker using the drilling template (item 1.9). For alignment of the mount, mark the position of the four notches (see a) on the side of the mount surface where the mount is to be glued to.

3. Affix AudioMount

Remove the red protection film completely and position the AudioMount concentrically to the drilling in the panel with use of the centering aid. Align horizontally or vertically by means of the four notches (a) and then press the AudioMount onto the panel. Break off the four pegs by pushing them inwards (b).

When installing an Interface Box (e.g., MX-232-IO-Box), you can glue it next to the AudioMount using the double-sided adhesive tape (item 1.9, see fig. c).

Notes: Recommended working temp. 5 to 20 °C (59 to 68 °F). The surface has to be clean, fat-free and dry. Press hard when attaching the mount (the glue is activated by pressure!)

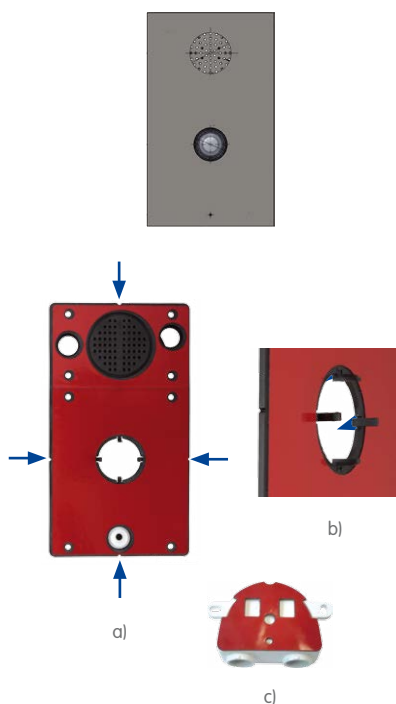

Installation of the Camera

1. Temporarily attach camera

To make the cable connection easy, temporarily attach the camera upside down onto the AudioMount with the two Allen screws (item 1.6).

2. Attach connection cables

Open the camera housing with a 2.5 mm Allen wrench (provided with the camera). Connect the required cables:

- Lead the AudioMount's microphone and speaker cables as well as the MxBus cables (when using MxBus modules) through the camera opening for additional cables and connect them (see S15 Camera Manual, Chapter 2).
- Insert the patch cable into the left opening of the camera and secure it with the blue bayonet catch (see S15 Camera Manual, Chapter 2).



Innovations - Made in Germany

The German company MOBOTIX AG is known as the leading pioneer in network camera technology and its decentralized concept has made high-resolution video systems cost efficient.

MOBOTIX AG • D-67722 Langmeil • Phone: +49 6302 9816-103 • Fax: +49 6302 9816-190 • sales@mobotix.com

- When using a solid core wire cable (instead of a patch cable), lead that cable through the camera opening for "additional" cables. Remove the bayonet catch on the left camera opening and insert the cable plug that holds the additional cables (see S15 Camera Manual, Chapter 2).
- If a USB device is to be connected, insert the MiniUSB cable into the MiniUSB plug (see S15 Camera Manual, Chapter 2).

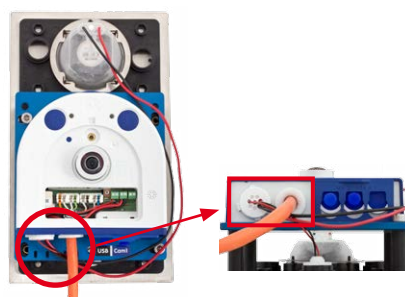

3. Attach housing cover

Attach the black front cover with dome included in the delivered parts (item 1.2) to the camera and fasten it in place. The previously removed white front cover is not needed.

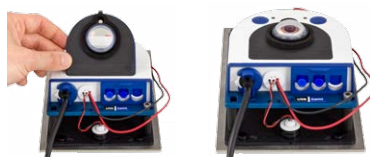

Setup of the Camera

You find detailed information to the standard installation in the S15 Camera Manual, Section 3 "Operating the Camera".

1. Establish PoE power supply

2. Put camera into operation

3. Optional: Start auto configuration

If you would like to use the FlexMount camera in conjunction with the AudioMount as a door station, you can run the auto configuration with the aid of the camera buttons now. To do this, reboot the camera by disconnecting and reconnecting the PoE power supply. After the reboot, press the camera buttons according to the description in the S15 Camera Manual, "Setting up an S15 FlexMount as a Door Station" and configure the connected door station modules (e.g., bell and DoorMaster).

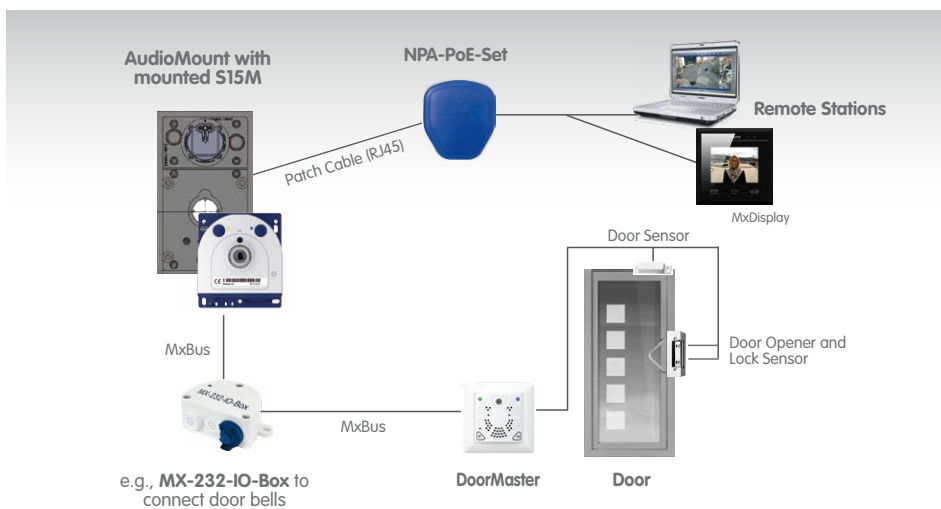

Finishing the Installation

1. Remove and re-attach camera

Remove the Allen screws (item 1.6), turn the camera around and attach it to the AudioMount. Make sure that you lead the cables on the left side around the four black mounting pegs. Screw the camera with the Allen wrench (item 1.7) to the mounting pegs using Allen screws (item 1.6) and metal washers (item 1.3).

Thickness of material: The AudioMount is constructed from sheet metals with a 3 mm thickness. If the material is less than 2.4 mm thick, additional washers have to be put between the mounting pegs and the back of the S15, so that the dome of the camera lens attains its optimal position.

2. Attach cable tie

Remove the protective foil from the cable tie (item 1.8) and stick it to the left side of the camera. Secure the audio cables with the cable tie.

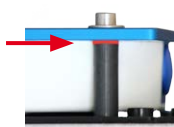
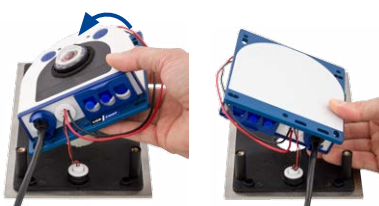

Thickness/Material	Washer
1.20 - 1.79 mm	blue
1.80 - 2.39 mm	red
2.40 - 3.00 mm	none

a)

b)

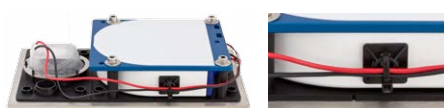

use-IP

www.use-ip.co.uk
01304 827609