



Technical Specifications



MOBOTIX T26B Door Station Camera

Hemispheric Door Station. Better Overview, More Security.

The high-resolution, hemispheric IP Video Door Station from MOBOTIX is an innovative, powerful solution that is easy to install. The T26 is based on the VoIP/SIP Video Intercom standard. All the modules offered for outdoor areas are weatherproof and maintenance-free and can be used in temperatures ranging from -30°C to 50°C (-22°F to 140°F).

- Mx6 system platform with H.264 and ONVIF compatibility
- Recording with sound, integrated mailbox function
- Available in day or night variants (6MP color or B&W sensor)
- Equipped with shock detector and MxAnalytics as standard
- Installation via CAT cable or two-wire cable
- Two-way video communication around the world
- Available in white, silver, dark gray or black

Please note:

As an alternative to the T26B, the S16B and T26B can also be used as a door station camera alternative.

A camera change from T25 to T26 in an existing door station is possible with further use of the other modules of the outdoor station after a system reconfiguration.





| Camera Variants | T26B Day Doorstation Camera | T26B Night Doorstation Camera |
|---|--|---|
| Specialties | Factory-assembled T26B Day or Night camera with sharply focused fisheye special lens, available in four housing colors | |
| Comparable standard colors (not exactly the MOBOTIX colors) | White: RAL 9016, Silver: RAL 9006, Dark Gray: DB 703, Black: RAL 9005 | |
| Objektive | T26B Day Doorstation Camera | T26B Night Doorstation Camera |
| Fisheye lens MX-B016 (f/2.0, Hemispheric 180° x 180°) | Mx-T26B-6D016 (white) Mx-T26B-6D016-b (black) Mx-T26B-6D016-s (silver) Mx-T26B-6D016-d (dark gray) | Mx-T26B-6N016 (white) Mx-T26B-6N016-b (black) Mx-T26B-6N016-s (silver) Mx-T26B-6N016-d (dark gray) |
| Hardware | T26B Day Doorstation Camera | T26B Night Doorstation Camera |
| Image sensor with individual exposure zones | Color | Black & White |
| Light sensitivity in lux at 1/60 s and 1/1 s | 0.1/0.005 | 0.02/0.001 |
| Image sensor (color or B/W sensor) | 1/1.8" CMOS, 6MP (3072 x 2048), Progressive Scan | |
| Microprocessor | i.MX 6 Dual Core incl. GPU (1 GB RAM, 512 MB Flash) | |
| H.264 Hardware Codec | Yes, bandwidth limitation available; output image format up to QXGA | |
| Protection classes | IP65 and IK10 | |
| Intended use | Not for use in hazardous areas (Ex area) | |
| Ambient temperature (range, incl. storage) | -30 to 50°C/-22 to 122°F (cold boot from -30°C/-22°F) | |
| Internal DVR, ex works | 4 GB (microSD) | |
| Microphone/Speaker | Yes/Yes | |
| Passive infrared sensor (PIR) | No | |
| Temperature sensor | Yes (live and audio messages) | |
| Shock detector (tamper detection) | Yes | |
| Power consumption (typically at 20°C/68°F) | 5 watts | |
| PoE Class (IEEE 802.3af) | Class 2 or 3 (variable), factory setting: class 3 | |
| Interfaces | 1x Ethernet 100BaseT (MxRJ45), 1x Ethernet 10/100 (LSA), MxBus, MiniUSB (MxMiniUSB), microphone, speaker | |
| Interface RS232 | With MX-232-IO-Box (Order Nr: MX-OPT-RS1-EXT) | |
| Mounting options | Wall | |
| Dimensions (Height x Width x Depth) | 99 x 99 x 60 mm | |
| Weight | 265 g | |
| Housing | PBT-30GF | |
| Standard delivery | Screws, dowl, cable plug, Allen wrench, Screw driver, 0,5 m Ethernet patch cable, Quick Install | |
| Detailed technical documentation | www.mobotix.com > Support > Download Center | |
| Online version of this document | www.mobotix.com > Support > Download Center | |
| MTBF | > 80,000 hours | |

| Hardware | T26B Day Doorstation Camera | T26B Night Doorstation Camera |
|---|---|-------------------------------|
| Certifications | EN55022:2010; EN55024:2010; EN50121-4:2006 EN61000-6-1:2007; EN 61000-6-2:2005 EN61000-6-3:2007+A1:2011 EN61000-6-4:2007+A1:2011 AS/ NZS CISPR22:2009+A1:2010 CFR47 FCC part15B | |
| Protocols | IPv4, IPv6, HTTP, HTTPS, FTP, FTPS, RTP, RTSP, UDP, SNMP, SMTP, DHCP (client and server), NTP (client and server), SIP (client and server) G.711 (PCMA and PCMU) and G.722 | |
| Manufacturer's warranty | 3 years | |
| Image Formats, Frame Rates, Image Storage | T26B Day Doorstation Camera | T26B Night Doorstation Camera |
| Available video codecs | MxPEG/MJPEG/H.264 | |
| Image formats | Freely configurable format 4:3, 8:3, 16:9 or customized format (Image Cropping), such as 2592x1944 (5MP), 2048x1536 (QXGA), 1920x1080 (Full-HD), 1280x960 (MEGA) | |
| Multistreaming | Yes | |
| Multicast stream via RTSP | Yes | |
| Max. image format | 6MP (3072 x 2048) | |
| Max. frame rate (fps, only single core used) | MxPEG: 42@HD(1280x720), 34@Full-HD, 24@QXGA, 15@5MP, 12@6MP MJPEG: 26@HD(1280x720), 13@Full-HD, 9@QXGA, 5@5MP, 4@6MP H.264: 25@Full-HD, 20@QXGA | |
| Number of images with 4 GB microSD (internal DVR) | CIF: 250.000, VGA: 125.000, HD: 40.000, QXGA: 20.000, 6MP: 10.000 | |
| General Functions | T26B Day Doorstation Camera | T26B Night Doorstation Camera |
| Digital zoom and pan | Yes | |
| ONVIF compatibility | Yes (Profile S) | |
| Genetec protocol integration | Yes | |
| Programmable exposure zones | Yes | |
| Snapshot recording (pre/post-alarm images) | Yes | |
| Continuous recording with audio | Yes | |
| Event recording with audio | Yes | |
| Time controlled flexible event logic | Yes | |
| Weekly schedules for recordings and actions | Yes | |
| Event video and image transfer via FTP and email | Yes | |
| Playback and QuadView via web browser | Yes | |
| Bidirectional audio in browser | Yes | |
| Animated logos on the image | Yes | |
| Master/Slave functionality | Yes | |
| Privacy zone scheduling | Yes | |
| Customized voice messages | Yes | |
| VoIP telephony (audio, alert) | Yes | |
| Remote alarm notification (network message) | Yes | |
| Programming interface (HTTP-API) | Yes | |
| DVR | Inside camera via microSD card, externally via USB device and NAS, different streams for live image and recording, MxFFS with archive function, pre-alarm an post-alarm images, monitoring recording with failure reporting | |

| General Functions | T26B Day Doorstation Camera | T26B Night Doorstation Camera |
|---|---|-------------------------------|
| Camera and data security | User and group management, SSL connections, IP-based access control, IEEE802.1x, intrusion detection, digital image signature | |
| MxMessageSystem: Sending and receiving of MxMessages | Yes | |
| Video Analysis | T26B Day Doorstation Camera | T26B Night Doorstation Camera |
| Video Motion Sensor | Yes | |
| MxActivitySensor | Yes | |
| MxAnalytics | Yes (Heatmaps, counting corridors and behavioural detection) | |
| Video Management Software | T26B Day Doorstation Camera | T26B Night Doorstation Camera |
| MxManagementCenter | Yes | |
| Mobile MOBOTIX App | Yes | |

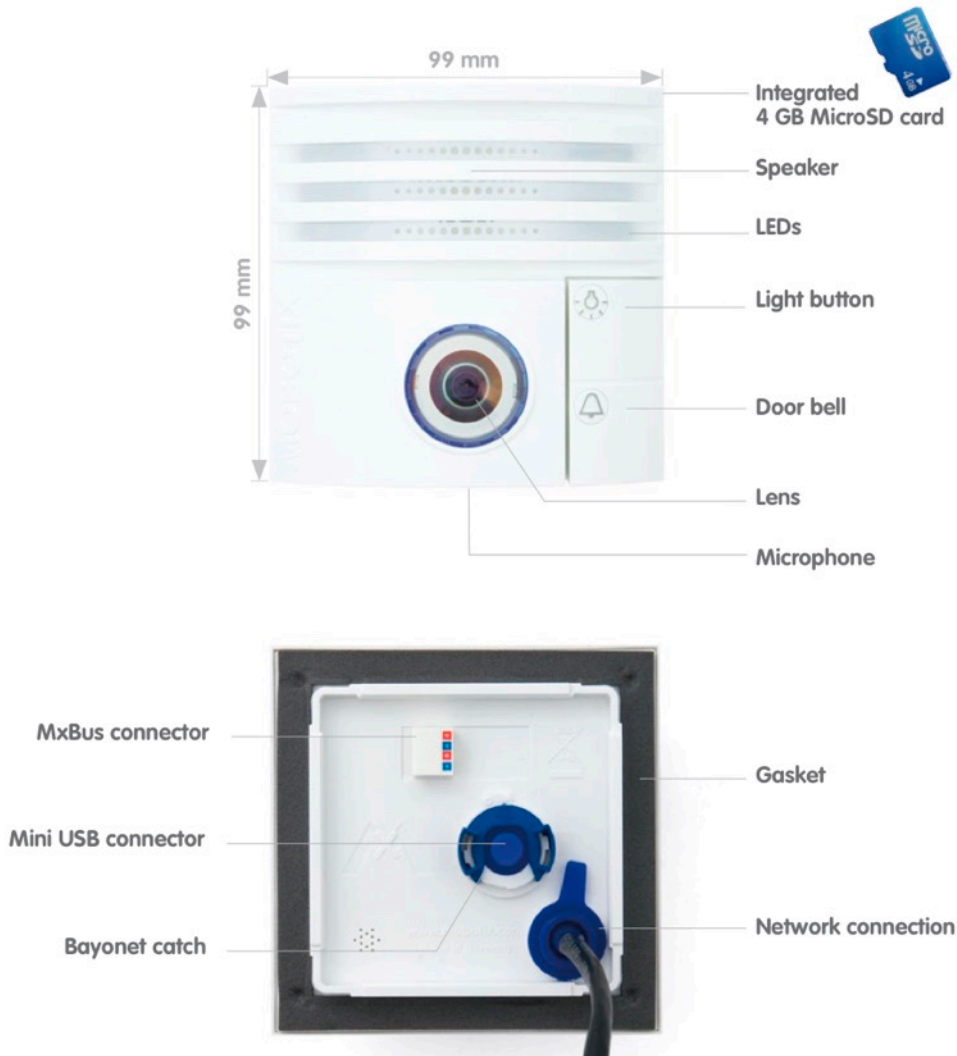

Safety Warning: Risk Of Overheating When Exposed To Direct Sunlight

When mounting a black or dark gray T26 IP Video Door Station in locations where the device is exposed to **direct sunlight**, the housing temperature can exceed the maximum allowed temperature limit. This can result in electronic failures and injuries especially when touching exterior metal parts. If the intended use of the device is at an (unprotected) outdoor location, you should only install **white or silver-colored** modules and frames. This product must not be installed within the reach of persons without the dome.

T26B Door Station and Access Modules: CamCore, Keypad, BellRFID



Intelligent. Powerful. Flexible.

The T26B with the latest Mx6 platform is here and the MOBOTIX product range of intelligent IoT systems is now complete! Outwardly unchanged compared to the T25 predecessor models, the innovations are in the inner workings. The change to the Mx6 dual core microprocessor technology offers above all an increase in performance, which benefits all computer-intensive image analysis functions such as MxAnalytics and thus enables higher frame rates.

Market opening with the industry standard ONVIF-S



The T26B camera platform also meets the requirements of the global, open interface standard ONVIF-S. In addition to the video codecs MxPEG and MJPEG, an H.264 stream can now also be generated. This makes MOBOTIX customers much more flexible and efficient when planning security solutions from individual components (cameras, recording devices, accessories, VM software).

Cost-effective modular system: T26B uses the accessory program of the T25 / T24 predecessor



The new T26B door station cameras are again available in the four familiar colors white, silver, dark gray and black, each with high-resolution 6MP day or night sensors. They can be combined with the same frames, housings, access modules, remote stations and accessories as the predecessor systems T25 and T24. An update only of the camera module is also technically possible with existing door stations.

Flexibility as a special advantage of the modular MOBOTIX IP Video Door Stations

Hardly any other manufacturer offers as many combination and usage options as MOBOTIX. Our Hemispheric Video Technology once again forms the centerpiece of the high-resolution T26. The modular system enables secure, keyless door opening via access code, RFID transponder and smartphone. In combination with several door stations, cameras and additional devices, individual access solutions of any size can be realized simply and inexpensively thanks to the IP standard.



With the new **MX-V5.2.0.x** firmware, the MOBOTIX cameras **S26B** and **S16B** (equipped with MxBUS connectors) can also be configured as door stations and used for individual installation solutions. The S26B with integrated miniature sensor module in the camera body can be concealed in the mailbox. With its two sensor modules positioned up to three meters from the housing, the S16B can even cover two areas at the same time (e.g., outside area and foyer).

T26B Camera Module (CamCore): Door camera with allround view with no blind spots



The hemispheric 360° lens covers the entire entrance area. No blind spots from wall to wall, from floor to ceiling. The camera can record events automatically, for example, when someone rings the doorbell or something moves in front of the door. The camera module can be used with a remote station as a compact basic Video Door Station, thanks to the integrated doorbell and light button. The 4 GB micro SD card can save 250 one-minute video clips or 60,000 individual VGA images.

BellRFID: A module for one to five bell buttons

The weatherproof BellRFID bell button module enables keyless entry via RFID transponder. The six different bell button sets can be easily replaced as required. Visitors can tap to leave messages, which can then be played back locally or remotely by residents.



KeypadRFID: Open door via PIN code or RFID card

The weatherproof KeypadRFID module enables keyless entry via RFID transponder and / or number combination, ringing at any number of remote stations via programmable key combinations and configuration of the Door Station without a PC. Includes mailbox function and transponder in check card format.



***Please note:** Since a previously used electronic module is no longer available on the market, all variants of BellRFID and KeypadRFID will each receive a successor model with identical appearance and functionality as part of a technically required facelift, but with new order numbers (see below). Initially, these new access modules can only be used in conjunction with the T26B and S26B / S16B. At the beginning of 2019, when the firmware update MX-V4.7.x is available for P3 cameras (x14 / x15 and x24 / x25), they can also be used with the T24 / T25 and S15M / S15D. All access modules delivered before the facelift are also compatible with the T26B and S26B / S16B.*

Info Module: Can also be connected via two-wire cable

The info module features a backlit house number field and can optionally include a Mx2wire+ unit. This unit is needed if the outdoor station is to be connected to the PoE switch with an existing bell wire via a second Mx2wire+ Indoor Unit instead of directly using an Ethernet cable.



MX-DoorMaster: Door opener module with battery power backup

The optional MX-DoorMaster with access code memory makes it impossible to open the door by forcibly separating and bridging the connection cables. A built-in rechargeable battery supplies both the electric door opener and the access module in the outdoor station and guarantees keyless access by transponder / code even in the event of a power failure for up to 60 hours. In addition, the MX-DoorMaster also serves as a doorbell indoors.



Due to the significantly greater demand for individually combinable door station individual modules, MOBOTIX no longer offers complete sets for the T26B.

Free App MxBell 2.0 makes the T26B Door Station even smarter

Do not miss a visitor thanks to push notification! MxBell displays the doorbell message of the new T26 IP Video Door Station on the smartphone or tablet. Open the door with it and use the intercom function. Check the last door station and camera recordings in Playback view. With automatic camera detection, secure remote connection over SSL and display of connection status. **MxBell 2.0 is available for free from the App Store and the Google Play Store (iOS 8 / Android 4.4+).**

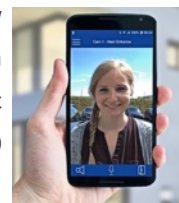

MOBOTIX T26B Door Station and Access Modules: Ordering Information

| Order Number | EAN | Description |
|-----------------|---------------|--|
| Mx-T26B-6D016 | 4047438032025 | Hemispheric IP door station camera with 6 Megapixel Moonlight Sensor, color (day) • ONVIF-S compliant Mx6 system platform (2nd generation) with H.264, MxPEG+ and M-JPEG • HD premium fisheye lens B016 (focal length 1.6 mm, f/2.0, 180° x 180°) • Max. image size: 6MP (3072 x 2048) • IP65, -30 to 50°C (-22 to 122°F) • Internal DVR: 4 GB microSD • LED lighting strips, two buttons (doorbell, outdoor light), temperature sensor, shock • detector, MxActivitySensor, MxAnalytics, ethernet patch cable 0.5 m/1.6 ft • Interfaces: Ethernet 10/100 (RJ45 and LSA), MxBus, USB • Color: White |
| Mx-T26B-6D016-b | 4047438032049 | like Mx-T26B-6D016, but in black color |
| Mx-T26B-6D016-s | 4047438032063 | like Mx-T26B-6D016, but in silver color |
| Mx-T26B-6D016-d | 4047438032087 | like Mx-T26B-6D016, but in dark gray color |
| Mx-T26B-6N016 | 4047438032032 | Hemispheric IP door station camera with 6 Megapixel Moonlight Sensor, B/W (night) • ONVIF-S compliant Mx6 system platform (2nd generation) with H.264, MxPEG+ and M-JPEG • HD premium fisheye lens B016 (focal length 1.6 mm, f/2.0, 180° x 180°) • Max. image size: 6MP (3072 x 2048) • IP65, -30 to 50°C (-22 to 122°F) • Internal DVR: 4 GB microSD • LED lighting strips, two buttons (doorbell, outdoor light), temperature sensor, shock • detector, MxActivitySensor, MxAnalytics, ethernet patch cable 0.5 m/1.6 ft • Interfaces: Ethernet 10/100 (RJ45 and LSA), MxBus, USB • Color: White |
| Mx-T26B-6N016-b | 4047438032056 | like Mx-T26B-6D016, but in black color |
| Mx-T26B-6N016-s | 4047438032070 | like Mx-T26B-6D016, but in silver color |
| Mx-T26B-6N016-d | 4047438032094 | like Mx-T26B-6D016, but in dark gray color |
| Mx-A-KEYC | 4047438034135 | Keypad access module for MOBOTIX T26 IP Video Door Stations • Incl. one admin and five user RFID cards • Doorbell function and mailbox control • Integrated RFID technology for keyless entry • Powered by the door camera via MxBus • Up to 60 hrs backup power supply using MX-DoorMaster (accessory) • Protection class IP65, -30 to 50°C / -22 to 122°F • Color: White |
| Mx-A-KEYC-b | 4047438034128 | like Mx-A-KEYC, but in black color |
| Mx-A-KEYC-s | 4047438034104 | like Mx-A-KEYC, but in silver color |
| Mx-A-KEYC-d | 4047438034111 | like Mx-A-KEYC, but in dark gray color |
| Mx-A-BELLC | 4047438034067 | BellRFID access module for MOBOTIX T26 IP Video Door Stations • For usage with any BellRFID Bell Button Set (to be ordered individually) • Incl. one admin and five user RFID cards • Doorbell function and mailbox control • Integrated RFID technology for keyless entry • Powered by the door camera via MxBus • Up to 60 hrs backup power supply using MX-DoorMaster (accessory) • Protection class IP65, -30 to 50°C / -22 to 122°F • Color: White |
| Mx-A-BELLC-b | 4047438034074 | like Mx-A-BELLC, but in black color |
| Mx-A-BELLC-s | 4047438034098 | like Mx-A-BELLC, but in silver color |
| Mx-A-BELLC-d | 4047438034081 | like Mx-A-BELLC, but in dark gray color |