

# MAYFLEX

## STP-DG500

### Digital keypad and proximity reader



This standalone keypad has a built-in proximity reader, enabling entry via PIN-codes or cards/fobs. Up to 500 users can be enrolled and assigned to two programmable output relays. Its robust metal casing gives a high degree of vandal resistance, and includes a tamper sensor. Variable open time and latching option. Ideal for offices, shops, clubs, etc.

#### Features

- Up to 500 user PINs, cards/fobs
- Built-in proximity reader
- 2 programmable relays.
- Selectable open-time (1 to 99 seconds)
- Latching mode (on aux relay only)
- Vandal resistant
- Tamper sensor
- Illuminated keypad (blue)
- LED status indication
- Button press 'beep' confirmation
- Cast alloy case (stainless steel colour)
- Card and PIN mode (more secure)

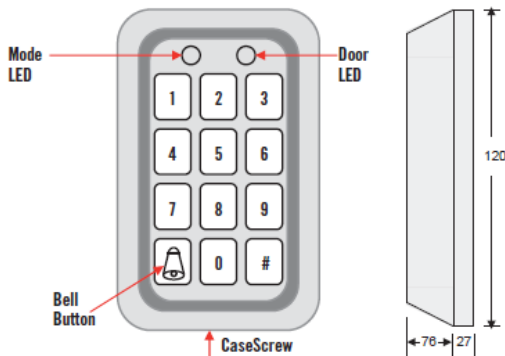

#### Technical Information

- Input voltage: 12Vdc
- Current draw: 130mA @ 12V,
- Relays: COM, NO, NC (2A max)
- Dims: 120mm(H) x 76mm(W) x 27mm(D)
- Proximity: EM format, 26 bit / 125kHz

#### Related Products

##### DG500-CARD



##### DG500-TAG



##### DG500 RAINHOOD



##### DG1000

