

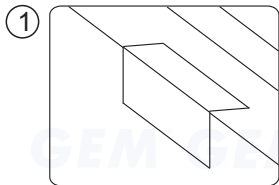

Application for the Electromagnet:
10010 Series 10060 Series (Double)

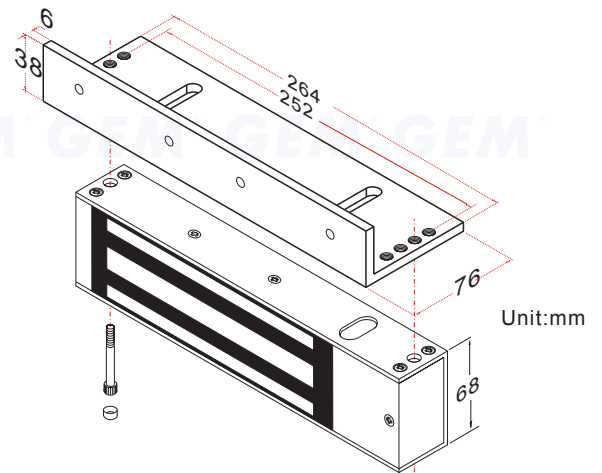

1 Fold the mounting template along the dotted line to a 90-degree angle. Close the door, place the template against the door and frame.

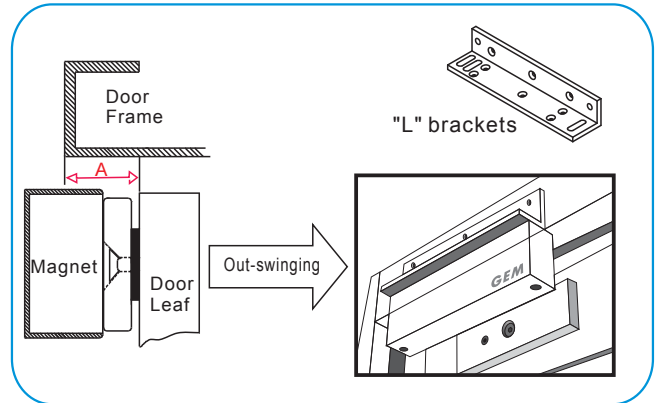
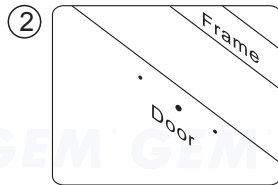

2 Drill three holes in the door as indicated on the template.

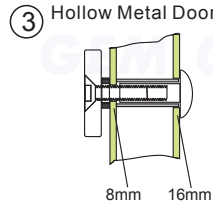

3 Hollow Metal Door
Drill an 8 mm hole through door, from sexnut bolt side only, enlarge the 8mm hole to 16mm.

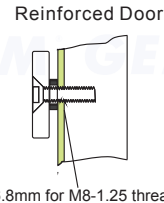

Reinforced Door
Drill an 6.8 mm dia. Hole and tap for M8x12.5 thread.

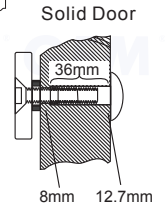

Solid Door
Drill an 8 mm hole thru door from sexnut bolt side of door, drill 12.7mmhole, 36mm in depth.

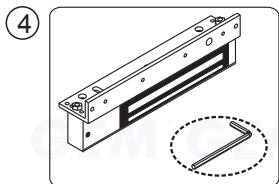

4 Use the Allen wrench to tighten the screws into the L bracket.

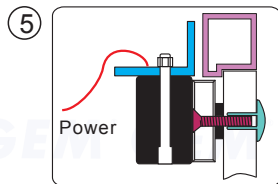

5 Turn on the power of EM-Lock, and let the armature plate bonds to the EM-lock. Adjust the position between the L bracket and the door frame.

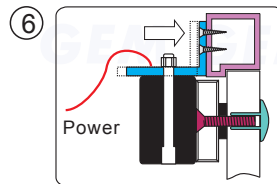

6 Once the position is correct, use the screws to permanently mount the L bracket on the door frame.

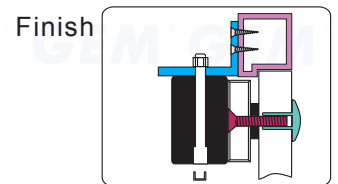

Finish
Test the unit. Insert the anti-tamper caps into the mounting screw access holes.